

Aqua Garden residential complex

Location **Kyrenia, Bahçeli**



About the project



Developer	Fenercioglu
Start of sale	01.06.2023
Key handover	2025
Houses/blocks	2
Building floor	2 Min 2 Max
Units total	4 - Studio, 28 - 1+1

Distance to the sea - 250 m
 Distance to key locations:
 Airport - 45 km, center - 5 km, beach - 250 m, Esentepe Hala Sahasa - 6 minutes, Esentepe Belediyesi - 6 minutes, Supermarket - 2 minutes, Kucuk Erenkoy Beach - 10 minutes, Karaagach Stadium - 8 minutes

The new luxury residential complex offers its residents not only high quality housing, but also a unique location in a resort on the Mediterranean coast. Immerse yourself in a world of luxury in Bahçeli, where FENERCIOGLU presents a modern residential project. Only 24 apartments are offered. Exclusivity at its best. Choose from studios, 1+1 or 2+1 configurations, each adapted to a different lifestyle - be it a garden, loft or terrace apartment. Each apartment is designed to capture the mesmerizing views of the sea, ensuring residents wake up to the serene sound of the waves every day.

Complex infrastructure

- Bar
- BBQ area
- Central generator
- Fitness centr.
- Kid's playground
- Open pool
- Parking
- Sauna

Available units **27** / 32 total

Median price per unit, K GBP

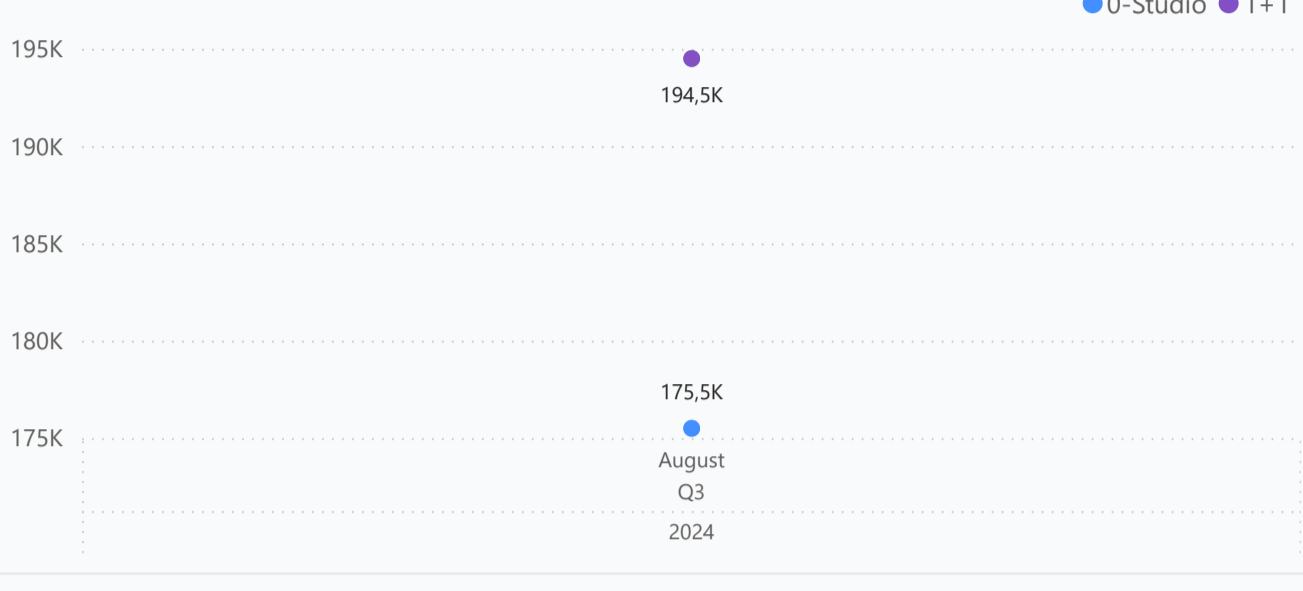

Structure of available units

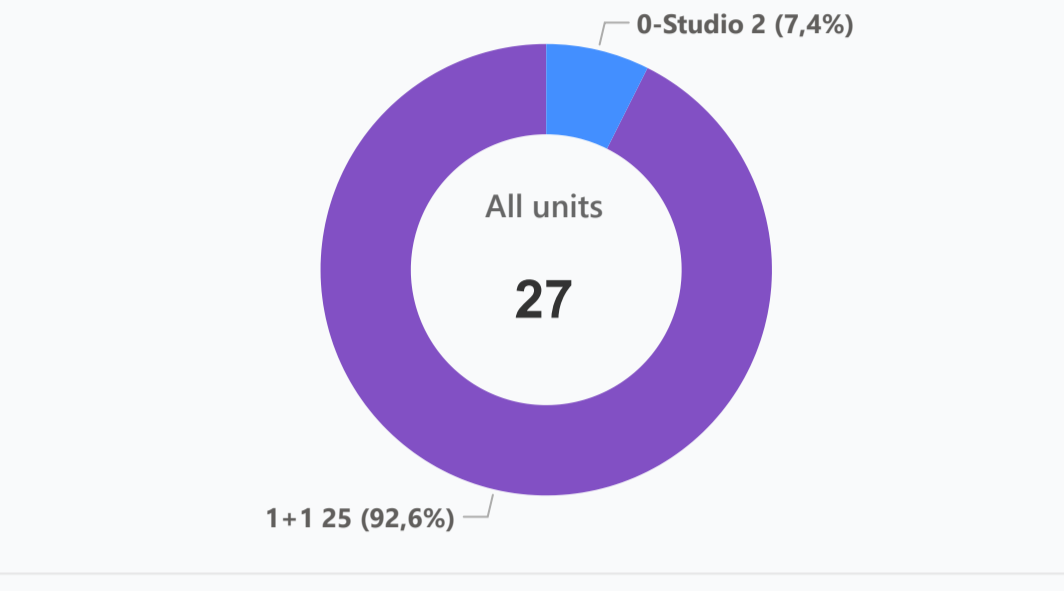

Plans

Type 4
NR (D BLOK) : 3,4

Type 3
NR (D BLOK) : 1,2

Type 2
NR (A,B,C BLOK) : 5,6,7,8

1+1 TERRACE

Payment plans

Deposit (non-refundable) NET

Option	Down payment	Installments months	Discount	Offer
Option 1	35 %	18	-	-
Option 2	-	-	-	-
Option 3	-	-	-	-
Option 4	-	-	-	-

Special offer

- Fully furnished design package
- Rental guarantee

- Trafo (Blank) GBP
- Resale -
- Maintenance fee -
- Rental services -

Details

Bedrooms	Subtype	Block	Unit №	Floor	View	Bathroom	Internal area, sq. m	Balcony/ Terrace, sq. m	Rooftop terrace, sq. m	Garden, sq. m	Gross covered area, sq. m	Current price, GBP	Price per sqm, GBP
0-Studio	Flat	A	1	0							57	175 500	3 079
0-Studio	Flat	A	2	0							57	175 500	3 079
1+1	Loft	B	1	0							79	194 500	2 462
1+1	Loft	B	2	0							79	194 500	2 462
1+1	Loft	B	3	0							79	194 500	2 462
1+1	Loft	B	10	0							79	217 500	2 753
1+1	Loft	B	11	0							79	217 500	2 753
1+1	Loft	B	4	0							79	217 500	2 753
1+1	Loft	B	5	0							79	217 500	2 753
1+1	Loft	B	6	0							79	217 500	2 753
1+1	Loft	B	7	0							79	217 500	2 753
1+1	Loft	B	8	0							79	217 500	2 753
1+1	Loft	B	9	0							79	217 500	2 753
1+1	Loft	B	12	0							79	234 500	2 968
1+1	Loft	B	13	0							79	234 500	2 968
1+1	Loft	B	14	0							79	234 500	2 968
1+1	Flat	B	18	01							85	175 500	2 065
1+1	Flat	B	19	01							85	175 500	2 065
1+1	Flat	B	20	01							85	175 500	2 065
1+1	Flat	B	21	01							85	175 500	2 065
1+1	Flat	B	22	01							85	175 500	2 065
1+1	Flat	B	23	01							85	175 500	2 065
1+1	Flat	B	24	01							85	175 500	2 065
1+1	Flat	B	25	01							85	175 500	2 065
1+1	Flat	B	26	01							85	193 500	2 276
1+1	Flat	B	27	01							85	193 500	2 276
1+1	Flat	B	28	01							85	193 500	2 276

Interior specification

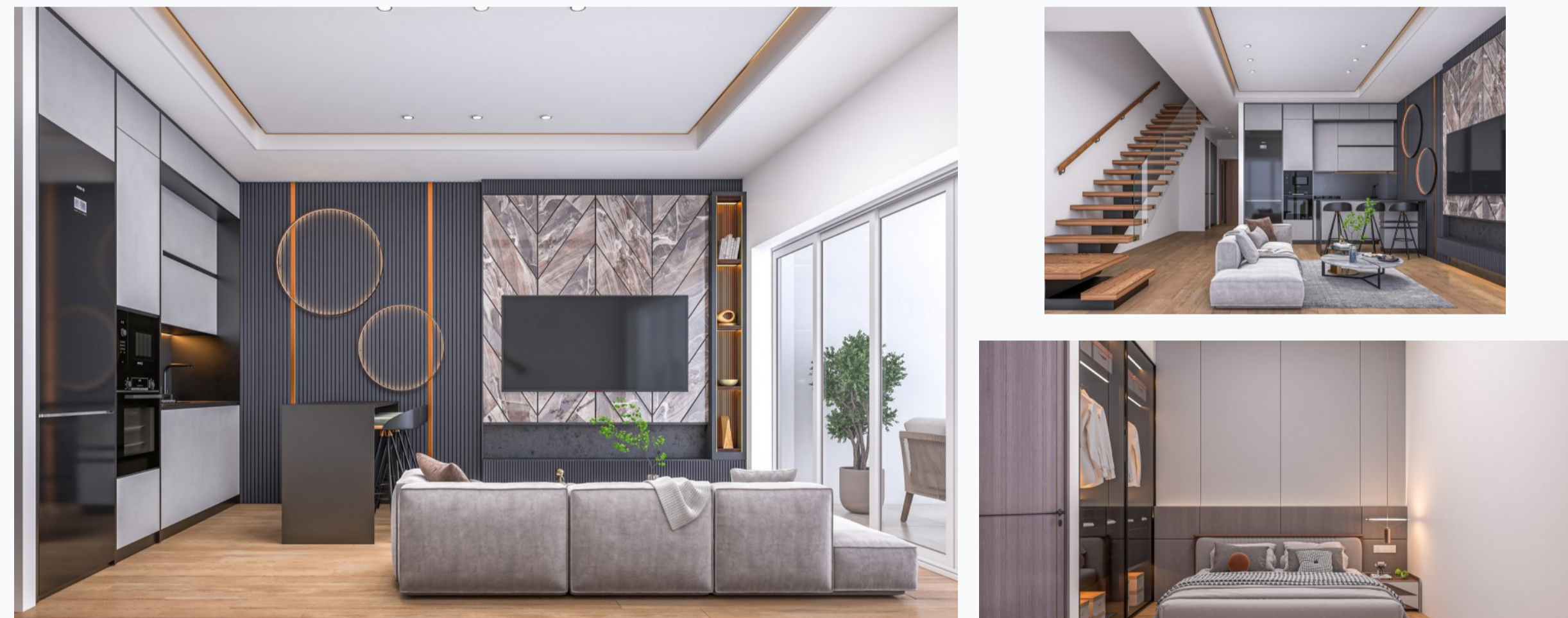

Interior specification

- Ceramic flooring
- Double glazed windows
- Laminate flooring in the bedrooms
- Toilet integrated in the walls

Exterior specification

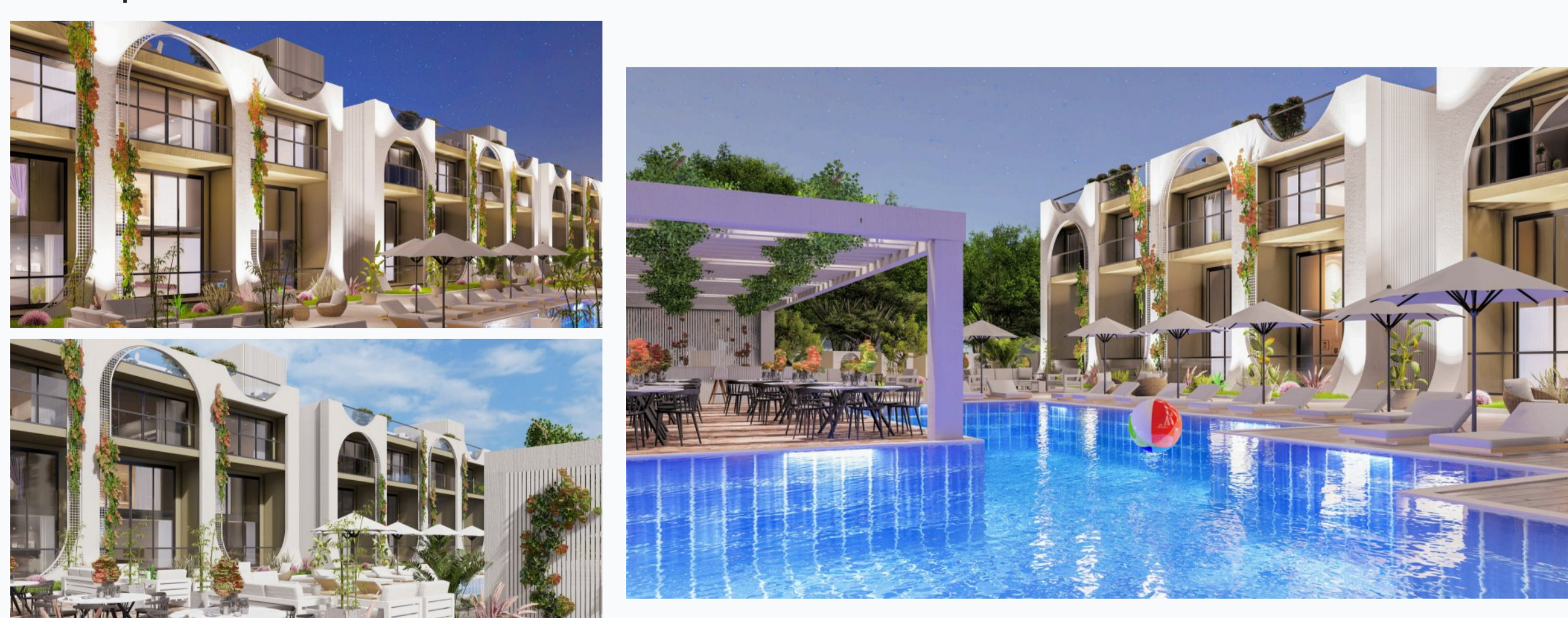

Exterior specification

- Glass fence balcony
- Terracing with inbuilt lighting & power sockets

Location of complex

